

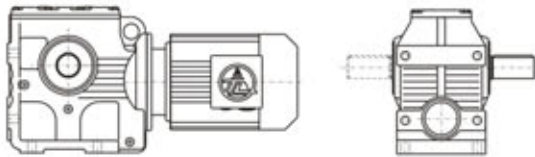

TS系列减速机有以下设计方案:

TS series gear units are available in the following designs:



TS..Y..

底脚轴伸式安装斜齿-蜗轮蜗杆减速机  
Foot-mounted helical-worm gear units with solid shaft

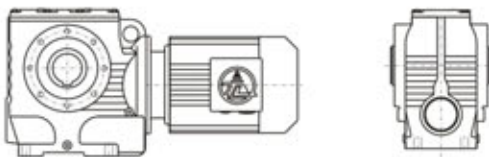

TSA...Y..

空心轴安装斜齿-蜗轮蜗杆减速机  
Helical-worm gear units with hollow shaft

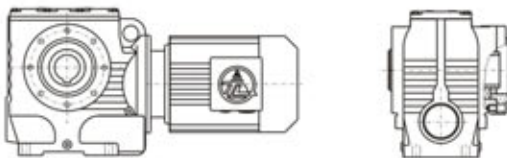

TSAZ...Y..

小法兰空心轴安装斜齿-蜗轮蜗杆减速机  
Short-flange mounted helical-worm gear units with hollow shaft



TSA ( TS, TSF, TSAF, TSAZ ) ...Y...

电机用户自配或配特殊电机时需加联接法兰  
When equipping the user's motor or the special one, the flange is required to be connected

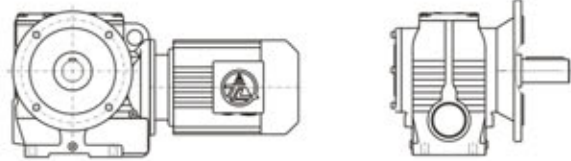

TSF...Y..

法兰轴伸式安装斜齿-蜗轮蜗杆减速机  
Flange-mounted helical-worm gear units with solid shaft

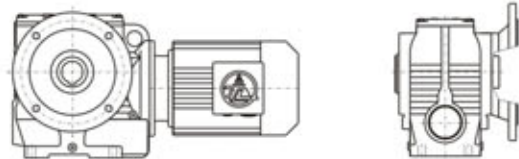

TSAF...Y..

法兰空心轴安装斜齿-蜗轮蜗杆减速机  
Flange-mounted helical-worm gear units with hollow shaft

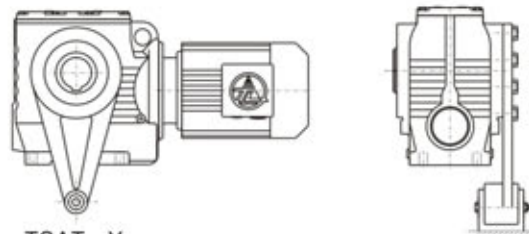

TSAT...Y..

带防转臂空心轴安装斜齿-蜗轮蜗杆减速机  
Torque-arm-mounted helical-worm gear units with hollow shaft

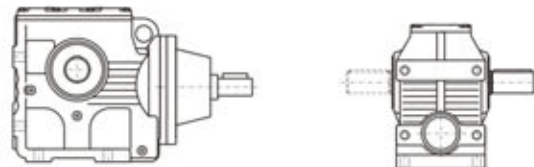

TS ( TSF, TSA, TSAF, TSAZ ) S...

轴输入的斜齿-蜗轮蜗杆减速机  
Shaft input helical-worm gear units

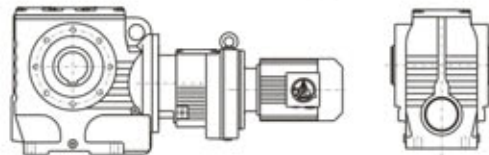

TSA ( TS, TSF, TSAF, TSAZ ) ...TR...Y...

组合式斜齿-蜗轮蜗杆减速机  
Combinatorial helical-worm gear units

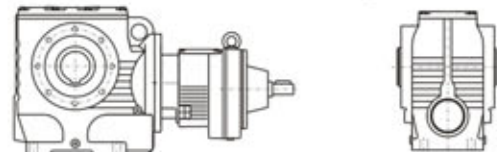

TSA ( TS, TSF, TSAF, TSAZ ) ...TRS ...

轴输入的组合式斜齿-蜗轮蜗杆减速机  
Shaft input combinatorial helical-worm gear units



型号与标记 / Type Designations

TS 48-Y 0.55-4P-32.40-M1-I-A -E -Φ25 -G	TS 48-Y 0.55-4P-32.40-M1-I-A -E -Φ25 -G
减速机类型 结构形式 规格 电机代号 电机功率、极数 传动比 安装形式 电机接线盒位置 输出轴、或法兰方向 锁紧盘方向 输出轴孔径 联接法兰	Gear units type Structure Size Motor code Motor power - pole Ratio Mounting position Position of the motor terminal box Position of output shaft, or flange The locking disk direction Output shaft aperture Coupling flange
减速机类型： 斜齿-蜗轮蜗杆减速机	Gear units type: Helical-worm gear units
结构形式：普通轴伸式（省略） 轴装式 A 轴伸法兰式 F 轴装法兰式 AF 轴装小法兰式 AZ 轴装带防转臂 AT 普通轴伸式，轴输入 S 普通轴装式，轴输入 AS 轴伸法兰式，轴输入 FS 轴装法兰式，轴输入 AFS 带锁紧盘式 H..(H, HF, HZ, HT)	Structure: Foot-mounted solid shaft output (-) Hollow shaft output A Flange-mounted solid shaft output F Flange-mounted hollow shaft output AF Short-flange-mounted hollow shaft output AZ Torque-arm-mounted hollow shaft output AT Foot-mounted solid shaft output, shaft input S Hollow shaft output, shaft input AS Flange-mounted solid shaft output, shaft input FS Flange-mounted hollow shaft output, shaft input AFS Hollow shaft output with shrink disk H..(H, HF, HZ, HT)
规格： （见选型参数表）	Size: (see selection table)
电机代号： 普通（更新） Y(Y2) 防爆 B 直流 Z 制动 E 多速 D 变频 V 分马力 F 增安 A 电磁调速 C 冶金起重 R 变频制动 VE 辊道 G 自配电机 ZP	Motor code: Ordinary(renew) Y(Y2) Flame-proof B Direct current Z Brake E Multi-speed D Variable frequency V Power-divided F Ampere-increased A Electromagnetism speed modulation C Hoisting in metallurgy R Variable frequency and brake VE Roller tables G With built-in motor ZP
电机功率、极数： （见选型参数表）	Motor power、pole : (see selection table)
传动比： （见选型参数表）	Ratio: (see selection table)
安装形式： M1、M2、M3、M4、M5、M6 (见第88页)	Mounting position: M1、M2、M3、M4、M5、M6(see page 88)
电机接线盒位置： I、II、III、IV、V、VI、VII、VIII(见第88页)	Position of the motor terminal box: I、II、III、IV、V、VI、VII、VIII (see page 88)
输出轴或法兰方向（锁紧盘）： 从电机尾部看左边为 A (E) 从电机尾部看右边为 B (F)（见安装形式） 从电机尾部看左右边为 A+B	Position of output shaft or flange (The locking disk) : viewing on motor end:left side -A, right side-B,both sides-A+B(see mounting position)
输出轴孔径： (见安装尺寸图)带实心轴输出时省略 联接法兰：配标准电机时用，直联电机省略	Output shaft aperture: (see the chart of mouting dimension) It will be omitted when solid output shaft

安装形式

Mounting position

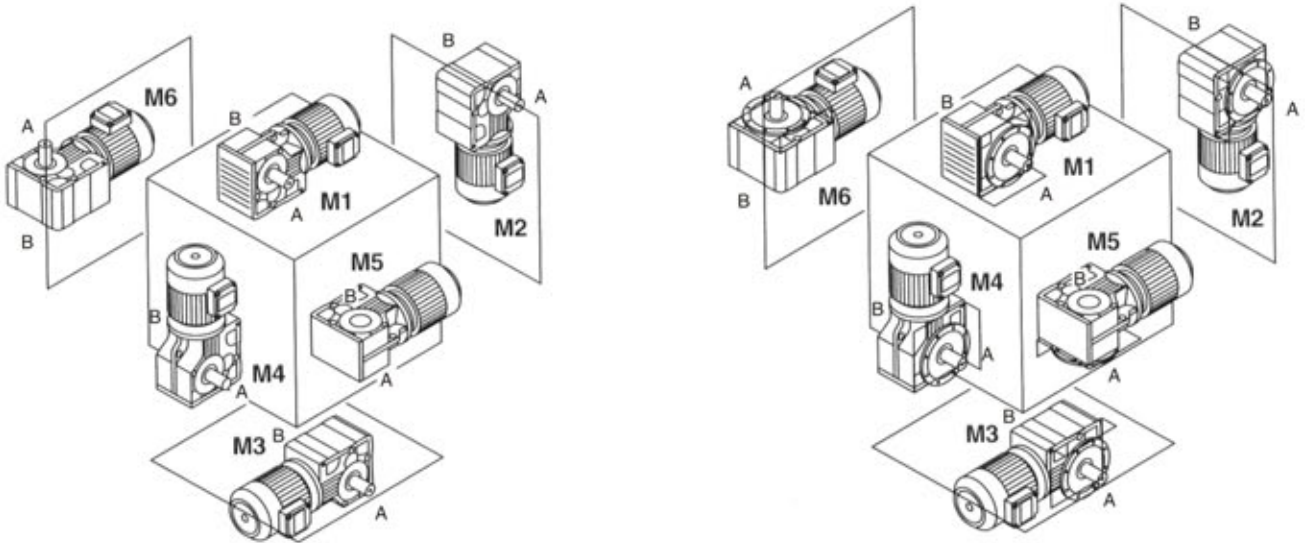

电机接线盒位置 (M1安装时, 从电机尾部看)

Position of the motor terminal box



输入功率及最大转矩\*

Input power rating and maximum torque

规格 Size	38	48	58	68	78	88	98
结构形式 Structure	TS TSA TSF TSAF TSAT TSAZ						
输入功率(kW) Input power rating	0.18~0.75	0.18~1.5	0.18~3	0.25~5.5	0.55~7.5	0.75~15	1.5~22
传动比 Ratio	10.27~152	11.46~244.74	10.78~196.21	11.55~227.20	9.96~241.09	11.83~222	12.75~230.48
最大转矩(N.m) Maximum torque	90	170	295	520	1270	2280	4000

\*) 最大转矩系指该规格不同传动比对应的最大转矩中的最大值。

\*) Maximum torque means the biggest one of the maximum torque related to the different ratio for the specified size.





减速机重量  
Gear unit weight

规格 Size	38	48	58	68	78	88	98
重量 (kg) Weight	9.5	15.5	16	33.5	53	100	170

所注重量为平均值, 仅供参考  
The weights are mean values, only for reference.

润滑油量表  
Lubrication table

TS...:

规格 Size	润滑油量 (升)			Fill quantity in liters		
	M1	M2	M3 <sup>1)</sup>	M4	M5	M6
TS38	0.44	0.56	0.61	0.67	0.56	0.56
TS48	0.67	0.8	0.89	1.1	0.8	0.8
TS58	1	1.4	1.5	1.6	1.4	1.4
TS68	1.8	2.2	3/3.9	3.2	2.6	2.6
TS78	3.9	5.2	4.3/6	6.2	4.9	4.9
TS88	6.6	9.6	7.6/11	12	9.9	9.3
TS98	12.7	19.1	17/21.5	22.6	19.5	19.5

TSF...:

规格 Size	润滑油量 (升)			Fill quantity in liters		
	M1	M2	M3 <sup>1)</sup>	M4	M5	M6
TSF38	0.44	0.56	0.61	0.67	0.56	0.56
TSF48	0.72	0.9	1.09	1.2	1.0	1.0
TSF58	1	1.4	1.5	1.7	1.5	1.5
TSF68	1.8	2.5	3.1/3.8	3.2	2.7	2.7
TSF78	3.9	5.1	4.5/6.4	6.7	5.4	5.4
TSF88	7.1	9.5	7.8/10.8	12	10	10
TSF98	13.3	19.1	17.2/22.2	23.8	20.5	20.5

TSA..., TSAF..., TSAZ...:

规格 Size	润滑油量 (升)			Fill quantity in liters		
	M1	M2	M3 <sup>1)</sup>	M4	M5	M6
TS..38	0.44	0.56	0.61	0.67	0.56	0.56
TS..48	0.72	0.8	0.89	1.1	0.8	0.8
TS..58	1	1.3	1.5	1.7	1.3	1.3
TS..68	1.8	2.3	2.6/3.4	2.9	2.5	2.5
TS..78	3.8	4.9	4.2/5.6	6.2	5	5
TS..88	7.1	8.9	6.7/9.4	11.2	8.9	8.9
TS..98	12.9	18.2	14.8/19.4	21.2	18.2	18.2

注: 1) 表示减速机为组合型时低速级所加油量为大值。

Notes: 1) The large gear unit of multi-stage gear units must be filled with the larger oil volume.

**选型参数表**  
Selection Table

输出转速 Output speed r/min	输出扭矩 Output torque Nm	传动比 Ratio i	服务系数 Service factor f <sub>s</sub>	机型号 Type Type	极数 Pole p	输出转速 Output speed r/min	输出扭矩 Output torque Nm	传动比 Ratio i	服务系数 Service factor f <sub>s</sub>	机型号 Type Type	极数 Pole p
<b>0.18kW</b>						<b>0.18kW</b>					
0.30	2563	4606	0.84			9.5	109	146.84	1.47		
0.36	2394	3872	0.90			10	102	137.25	1.57		
0.40	2579	3475	0.83	TS 88TR58	4	12	88	118.64	1.82	TS 48	4
0.48	2515	2905	0.85	TSF 88TR58	4	14	75	100.80	2.14	TSF 48	4
0.54	2239	2586	0.96	TSA 88TR58	4	15	67	90.00	2.40	TSA 48	4
0.60	2021	2335	1.06	TSAF88TR58	4	18	57	76.88	2.80	TSAF48	4
0.68	1778	2054	1.21			19	53	72.00	2.99		
0.76	1579	1824	1.36			23	45	60.65	3.56		
0.85	1412	1631	1.52								
0.99	1215	1404	0.98			9.1	113	152.00	0.80		
1.1	1078	1245	1.11			11	96	129.41	0.89		
1.3	952	1100	1.25	TS 78TR38	4	12	83	111.58	1.03		
1.5	826	954	1.45	TSF 78TR38	4	13	77	104.00	1.10		
1.7	725	837	1.65	TSA 78TR38	4	15	67	90.91	1.26		
1.9	618	714	1.93	TSAF78TR38	4	16	63	85.22	1.34		
2.2	551	637	2.2			18	56	75.20	1.52		
2.4	497	574	2.4			21	49	66.67	1.72		
						25	42	56.67	2.02		
						27	45	52.00	1.89	TS 38	4
						31	39	45.45	2.16	TSF 38	4
						33	37	42.61	2.30	TSA 38	4
						37	33	37.60	2.61	TSAF38	4
						42	29	33.33	2.95		
						49	25	28.33	3.47		
						59	23	23.46	3.66		
						74	19	18.85	4.56		
						84	16	16.48	5.21		
						90	15	15.45	5.56		
						102	13	13.63	6.30		
						115	12	12.08	7.11		
						135	10	10.27	8.37		
						<b>0.25kW</b>					
						0.48	2495	2905	0.86		
						0.54	2221	2586	0.96		
						0.60	2406	2335	0.89	TS 88TR58	4
						0.68	2470	2054	0.87	TSF 88TR58	4
						0.76	2193	1824	0.98	TSA 88TR58	4
						0.85	1961	1631	1.09	TSAF88TR58	4
						1.5	1118	930	1.92		
						1.5	1147	954	1.04		
						1.7	1006	837	1.19	TS 78TR38	4
						1.9	858	714	1.39	TSF 78TR38	4
						2.2	766	637	1.56	TSA 78TR38	4
						2.4	690	574	1.73	TSAF78TR38	4
						2.8	600	499	1.99		
						2.6	560	543	0.87		
						3.0	564	469	0.87	TS 68TR38	4
						3.3	510	424	0.96	TSF 68TR38	4
						3.8	439	365	1.11	TSA 68TR38	4
						4.4	384	319	1.27	TSAF68TR38	4
						4.9	338	281	1.45		
						4.7	353	294	0.80		
						5.2	323	269	0.87		
						6.1	275	229	1.02	TS 58TR18	4
						6.8	245	204	1.15	TSF 58TR18	4
						7.4	225	187	1.25	TSA 58TR18	4
						8.4	198	165	1.42	TSAF58TR18	4
						11	158	131	1.79		
						2.8	505	227.20	0.97		
						3.1	456	205.11	1.07	TS 68	8
						3.6	401	180.46	1.22	TSF 68	8
						3.8	378	170.40	1.29	TSA 68	8
						4.5	320	144.00	1.53	TSAF68	8
						5.1	204	168.00	0.81		
						5.7	182	150.00	0.88	TS 48	6
						5.8	178	146.84	0.90	TSF 48	6
						6.2	167	137.25	0.96	TSA 48	6
						7.2	144	118.64	1.11	TSAF48	6
						5.7	182	244.74	0.88	TS 48	4
						6.1	170	228.75	0.94	TSF 48	4
						7.0	147	197.73	1.09	TSA 48	4
						8.3	125	168.00	1.28	TSAF48	4
						9.3	111	150.00	1.44		

选型参数表  
Selection Table



输出转速 Output speed r/min	输出扭矩 Output torque Nm	传动比 Ratio i	服务系数 Service factor f <sub>s</sub>	机型号 Type Type	极数 Pole p	输出转速 Output speed r/min	输出扭矩 Output torque Nm	传动比 Ratio i	服务系数 Service factor f <sub>s</sub>	机型号 Type Type	极数 Pole p
<b>0.25kW</b>						<b>0.37kW</b>					
3.7	383	227.20	1.28			0.68	2611	2054	0.82	TS 88TR58	4
4.1	346	205.11	1.41	TS 68	6	0.76	2318	1824	0.92	TSF 88TR58	4
4.7	304	180.46	1.61	TSA 68	6	0.85	2488	1631	0.86	TSA 88TR58	4
5.0	287	170.40	1.70	TSAF68	6	1.5	1655	930	1.29	TSAF88TR58	4
5.9	243	144.00	2.01			1.7	1479	831	1.45		
6.1	234	227.20	2.09			1.9	1271	714	0.94		
6.8	211	205.11	2.31			2.2	1134	637	1.05	TS 78TR38	4
7.7	186	180.46	2.63	TS 68	4	2.4	1021	574	1.17	TSF 78TR38	4
8.2	176	170.40	2.78	TSF 68	4	2.8	888	499	1.34	TSA 78TR38	4
9.7	148	144.00	3.30	TSA 68	4	3.2	779	438	1.53	TSAF78TR38	4
11	134	130.00	3.65	TSAF68	4	3.6	692	389	1.72		
12	118	114.38	4.15			3.8	557	365	0.88	TS 68TR38	4
13	111	108.00	4.39			4.4	568	319	0.86	TSF 68TR38	4
4.3	331	196.21	0.85	TS 58	6	4.9	500	281	0.98	TSA 68TR38	4
4.7	304	180.40	0.93	TSF 58	6	5.7	438	246	1.12	TSAF68TR38	4
5.5	260	154.35	1.08	TSA 58	6						
6.4	225	133.79	1.25	TSAF58	6						
6.8	211	125.05	1.34			3.0	702	222.00	3.03	TS 88	8
						3.4	627	198.00	3.42	TSF 88	8
						4.0	527	166.43	4.07	TSA 88	8
										TSAF88	8
7.1	202	196.21	1.39			2.8	763	241.09	1.57	TS 78	8
7.7	186	180.40	1.52			3.3	652	206.04	1.83	TSF 78	8
9.0	159	154.35	1.77	TS 58	4	3.5	598	188.89	2.00	TSA 78	8
10	138	133.79	2.05	TSF 58	4	4.0	524	165.75	2.28	TSAF78	8
11	129	125.05	2.19	TSA 58	4	4.3	497	157.08	2.40		
13	111	108.09	2.53	TSAF58	4						
15	95	91.84	2.98			3.9	544	227.20	0.90	TS 68	6
17	85	82.00	3.34			4.3	491	205.11	1.00	TSF 68	6
						4.9	432	180.46	1.13	TSA 68	6
						5.2	408	170.40	1.20	TSAF68	6
						6.1	345	144.00	1.42		
7.0	204	197.73	0.81			6.1	347	227.20	1.41		
8.3	173	168.00	0.92			6.8	313	205.11	1.56		
9.3	155	150.00	1.04			7.7	275	180.46	1.78	TS 68	4
9.5	151	146.84	1.06			8.2	260	170.40	1.88	TSF 68	4
10	141	137.25	1.13			9.7	220	144.00	2.23	TSA 68	4
12	122	118.64	1.31	TS 48	4	11	198	130.00	2.47	TSAF68	4
14	104	100.80	1.54	TSF 48	4	12	174	114.38	2.80		
15	93	90.00	1.73	TSA 48	4						
18	79	76.88	2.02	TSAF48	4	5.7	370	154.35	0.81		
19	74	72.00	2.16			6.6	321	133.79	0.88	TS 58	6
23	63	60.65	2.56			7.1	300	125.05	0.94	TSF 58	6
23	71	59.32	2.24			8.2	259	108.09	1.09	TSA 58	6
28	61	50.40	2.64			9.6	220	91.84	1.28	TSAF58	6
31	54	45.00	2.96			10.8	196	82.00	1.44		
13	107	104.00	0.81			7.1	299	196.21	0.94		
15	94	90.91	0.91			7.7	275	180.40	1.02		
16	88	85.22	0.97			9.0	235	154.35	1.20		
18	77	75.20	1.10			10	204	133.79	1.38		
21	69	66.67	1.24			11	191	125.05	1.48	TS 58	4
25	58	56.67	1.46			13	165	108.09	1.71	TSF 58	4
27	63	52.00	1.36			15	140	91.84	2.01	TSA 58	4
31	55	45.45	1.56			17	125	82.00	2.25	TSAF58	4
33	51	42.61	1.66			20	107	70.04	2.64		
37	45	37.60	1.88	TS 38	4	21	119	66.89	2.37		
42	40	33.33	2.12	TSF 38	4	22	111	62.53	2.53		
49	34	28.33	2.50	TSA 38	4						
59	32	23.46	2.64	TSAF38	4	10	209	137.25	0.80	TS 48	4
74	26	18.85	3.28			12	181	118.64	0.88	TSF 48	4
84	23	16.48	3.75			14	154	100.80	1.04	TSA 48	4
90	21	15.45	4.00			15	137	90.00	1.17	TSAF48	4
102	19	13.63	4.54			18	117	76.88	1.36		
115	17	12.08	5.12								
135	14	10.27	6.02								



**选型参数表**  
Selection Table

输出转速	输出扭矩	传动比	服务系数	机型号	极数	输出转速	输出扭矩	传动比	服务系数	机型号	极数
Output speed	Output torque	Ratio	Service factor	Type	Pole	Output speed	Output torque	Ratio	Service factor	Type	Pole
r/min	Nm	i	f <sub>s</sub>	Type	p	r/min	Nm	i	f <sub>s</sub>	Type	p
<b>0.37kW</b>						<b>0.55kW</b>					
19	110	72.00	1.46			3.7	859	241.09	1.39		
23	93	60.65	1.73			4.3	734	206.04	1.63	TS 78	6
23	106	59.32	1.52			4.7	673	188.89	1.78	TSF 78	6
28	90	50.40	1.78			5.3	590	165.75	2.02	TSA 78	6
31	80	45.00	2.00	TS 48	4	5.6	559	157.08	2.13	TSAF78	6
36	68	38.44	2.34	TSF 48	4						
39	64	36.00	2.50	TSA 48	4	5.8	547	241.09	2.18	TS 78	4
46	54	30.33	2.96	TSAF48	4	6.7	467	206.04	2.56	TSF 78	4
50	56	27.74	2.84			7.4	428	188.89	2.79	TSA 78	4
54	53	25.93	3.03							TSAF78	4
62	46	22.41	3.51			6.1	515	227.20	0.95		
73	39	19.04	4.13			6.8	465	205.11	1.05		
82	35	17.00	4.63			7.7	409	180.46	1.20		
						8.2	386	170.40	1.27		
21	102	66.67	0.84			9.7	326	144.00	1.50	TS 68	4
25	86	56.67	0.98			11	295	130.00	1.66	TSF 68	4
27	93	52.00	0.92			12	259	114.38	1.89	TSA 68	4
31	81	45.45	1.05			13	245	108.00	2.00	TSAF68	4
33	76	42.61	1.12			15	208	91.96	2.35		
37	67	37.60	1.27	TS 38	4	17	189	83.57	2.58		
42	59	33.33	1.43	TSF 38	4	19	164	72.39	2.98		
49	50	28.33	1.69	TSA 38	4	21	172	65.00	2.84		
59	48	23.46	1.78	TSAF38	4						
74	38	18.85	2.22			9.6	327	91.84	0.86		
84	34	16.48	2.54			11	292	82.00	0.97		
90	31	15.45	2.71			13	251	70.40	1.12	TS 58	6
102	28	13.63	3.07			13	278	66.89	1.01	TSF 58	6
115	25	12.08	3.46			14	260	62.53	1.09	TSA 58	6
135	21	10.27	4.07			16	225	54.05	1.26	TSAF58	6
						19	191	45.92	1.48		
						22	170	41.00	1.66		
						25	146	35.20	1.93		
<b>0.55kW</b>						<b>0.55kW</b>					
1.0	2517	1332	0.85			9.0	350	154.35	0.81		
1.2	2475	1191	0.87			10	303	133.79	0.93		
1.3	2340	1032	0.92	TS 88TR58	4	11	284	125.05	0.99		
1.5	2460	930	0.87	TSF 88TR58	4	13	245	108.09	1.15		
1.7	2198	831	0.97	TSA 88TR58	4	15	208	91.84	1.35		
1.9	1902	719	1.13	TSAF88TR58	4	17	186	82.00	1.52		
2.2	1651	624	1.30			20	160	70.40	1.77		
2.5	1476	558	1.45			21	177	66.89	1.59	TS 58	4
3.2	1151	435	1.86			22	165	62.53	1.70	TSF 58	4
						26	143	54.05	1.97	TSA 58	4
2.8	1320	499	0.90			30	121	45.92	2.32	TSAF58	4
3.2	1159	438	1.03	TS 78TR38	4	34	108	41.00	2.60		
3.6	1029	389	1.16	TSF 78TR38	4	40	93	35.02	3.04		
4.3	865	327	1.38	TSA 78TR38	4	42	87	32.80	3.25		
4.8	764	289	1.56	TSAF78TR38	4	46	91	30.12	3.10		
5.6	661	250	1.81			53	79	26.11	3.57		
						57	74	24.40	3.82		
5.7	558	246	0.88	TS 68TR38	4	66	64	21.09	4.42		
6.3	585	221	0.84	TSF 68TR38	4						
7.0	524	198	0.93	TSA 68TR38	4	18	174	76.88	0.92		
8.3	444	168	1.10	TSAF68TR38	4	19	163	72.00	0.98		
						23	138	60.65	1.16		
3.0	1044	222.00	2.05	TS 88	8	23	157	59.32	1.02		
3.4	931	198.00	2.30	TSF 88	8	28	133	50.40	1.20		
4.0	783	166.43	2.74	TSA 88	8	31	119	45.00	1.34		
				TSAF88	8	36	102	38.44	1.57	TS 48	4
						39	95	36.00	1.68	TSF 48	4
4.0	791	222.00	2.71	TS 88	6	46	80	30.33	1.99	TSA 48	4
4.5	705	198.00	3.04	TSF 88	6	50	84	27.74	1.91	TSAF48	4
5.3	593	166.43	3.62	TSA 88	6	54	78	25.93	2.04		
				TSAF88	6	62	68	22.41	2.36		
						73	58	19.04	2.78		
3.3	969	206.04	1.23	TS 78	8	82	51	17.00	3.11		
3.5	888	188.89	1.34	TSF 78	8	96	44	14.52	3.65		
4.0	780	165.75	1.53	TSA 78	8	102	41	13.60	3.89		
4.3	739	157.08	1.62	TSAF78	8	121	35	11.46	4.62		

选型参数表  
Selection Table



输出转速 Output speed r/min	输出扭矩 Output torque Nm	传动比 Ratio i	服务系数 Service factor f <sub>s</sub>	机型号 Type Type	极数 Pole p	输出转速 Output speed r/min	输出扭矩 Output torque Nm	传动比 Ratio i	服务系数 Service factor f <sub>s</sub>	机型号 Type Type	极数 Pole p
<b>0.55kW</b>						<b>0.75kW</b>					
42	88	33.33	0.96			6.8	634	205.11	0.80		
49	75	28.33	1.13			7.7	558	180.46	0.88		
59	71	23.46	1.20			8.2	527	170.40	0.93		
74	57	18.85	1.49	TS 38	4	9.7	445	144.00	1.10		
84	50	16.48	1.71	TSF 38	4	11	402	130.00	1.22		
90	47	15.45	1.82	TSA 38	4	12	354	114.38	1.38	TS 68	4
102	41	13.63	2.06	TSAF38	4	13	334	108.00	1.46	TSF 68	4
115	37	12.08	2.33			15	284	91.96	1.72	TSA 68	4
135	31	10.27	2.74			17	258	83.57	1.89	TSAF68	4
						19	224	72.39	2.18		
<b>0.75kW</b>						21	234	65.00	2.09		
1.1	4411	1223	0.85			22	195	63.00	2.51		
1.3	3860	1070	0.97			24	206	57.19	2.37		
1.5	3347	928	1.12	TS 98TR58	4	26	195	54.00	2.51		
1.7	2972	824	1.27	TSF 98TR58	4	30	166	45.98	2.95		
1.9	2575	714	1.46	TSA 98TR58	4						
2.2	2258	626	1.67	TSAF98TR58	4	13	331	70.04	0.85		
2.6	1941	538	1.94			14	369	66.89	0.80	TS 58	6
2.9	1746	484	2.2			15	345	62.53	0.82	TSF 58	6
						17	298	54.05	0.95	TSA 58	6
1.3	2659	1032	0.81			20	253	45.92	1.11	TSAF58	6
1.5	2396	930	0.89			22	226	41.00	1.25		
1.7	2569	831	0.83	TS 88TR58	4						
1.9	2593	719	0.83	TSF 88TR58	4	13	334	108.09	0.84		
2.2	2251	624	0.95	TSA 88TR58	4	15	284	91.84	0.99		
2.5	2013	558	1.06	TSAF88TR58	4	17	254	82.00	1.11		
3.2	1569	435	1.37			20	217	70.04	1.30		
4.3	1165	323	1.84			21	241	66.89	1.17		
						22	226	62.53	1.25		
4.3	1179	327	1.01	TS 78TR38	4	26	195	54.05	1.45		
4.8	1042	289	1.15	TSF 78TR38	4	30	166	45.92	1.70	TS 58	4
5.6	902	250	1.32	TSA 78TR38	4	34	148	41.00	1.91	TSF 58	4
6.3	790	219	1.51	TSAF78TR38	4	40	126	35.02	2.23	TSA 58	4
						42	118	32.80	2.38	TSAF58	4
3.0	1457	230.48	2.58	TS 98	8	46	124	30.12	2.27		
3.3	1311	207.48	2.87	TSF 98	8	53	108	26.11	2.62		
3.6	1187	187.89	3.17	TSA 98	8	57	101	24.40	2.80		
						66	87	21.09	3.24		
4.1	1048	222.00	2.04	TS 88	6	78	74	17.92	3.82		
4.6	935	198.00	2.29	TSF 88	6	87	66	16.00	4.28		
5.5	786	166.43	2.73	TSA 88	6	102	56	13.67	5.00		
6.2	690	223.26	3.10	TS 88	4	31	162	45.00	0.99		
7.0	612	198.00	3.50	TSF 88	4	36	139	38.44	1.15		
8.4	515	166.43	4.16	TSA 88	4	39	130	36.00	1.23		
						46	109	30.33	1.46	TS 48	4
3.8	1139	241.09	1.05	TS 78	6	50	114	27.74	1.40	TSF 48	4
4.4	973	206.04	1.23	TSF 78	6	54	107	25.93	1.50	TSA 48	4
4.8	892	188.89	1.34	TSA 78	6	62	92	22.41	1.73	TSAF48	4
5.5	783	165.75	1.53	TSAF78	6	73	78	19.04	2.04		
						82	70	17.00	2.28		
5.8	745	241.09	1.60			96	60	14.52	2.67		
6.7	637	206.04	1.87			102	56	13.60	2.85		
7.4	584	188.89	2.04	TS 78	4	121	47	11.46	3.39		
8.4	512	165.75	2.33	TSF 78	4						
8.8	486	157.08	2.46	TSA 78	4	74	78	18.85	1.09		
10	425	137.48	2.81	TSAF78	4	84	68	16.48	1.25	TS 38	4
11	383	123.86	3.12			90	64	15.45	1.33	TSF 38	4
13	336	108.65	3.55			102	56	13.63	1.51	TSA 38	4
						115	50	12.08	1.71	TSAF38	4
						135	42	10.27	2.01		



**选型参数表**  
Selection Table

输出转速 Output speed r/min	输出扭矩 Output torque Nm	传动比 Ratio i	服务系数 Service factor f <sub>s</sub>	机型号 Type Type	极数 Pole p	输出转速 Output speed r/min	输出扭矩 Output torque Nm	传动比 Ratio i	服务系数 Service factor f <sub>s</sub>	机型号 Type Type	极数 Pole p
<b>1.1kW</b>						<b>1.1kW</b>					
1.7	4328	824	0.87			20	315	70.04	0.89		
2.0	3750	714	1.00	TS 98TR58	4	21	351	66.89	0.80		
2.2	3288	626	1.14	TSF 98TR58	4	22	328	62.53	0.86		
2.6	2826	538	1.33	TSA 98TR58	4	26	284	54.05	0.99		
2.9	2542	484	1.48	TSAF98TR58	4	30	241	45.92	1.17		
3.3	2206	420	1.70			34	215	41.00	1.31		
						40	184	35.02	1.53	TS 58	4
2.2	2341	624	0.92			43	172	32.80	1.64	TSF 58	4
2.5	2512	558	0.85			54	157	26.11	1.80	TSA 58	4
2.9	2547	485	0.84			57	146	24.40	1.93	TSAF58	4
3.2	2285	435	0.94	TS 88TR58	4	66	127	21.09	2.23		
3.7	1985	378	1.08	TSF 88TR58	4	78	108	17.92	2.62		
4.3	1697	323	1.26	TSA 88TR58	4	88	96	16.00	2.94		
5.0	1476	281	1.45	TSAF88TR58	4	102	82	13.67	3.44		
5.5	1339	255	1.60			109	77	12.80	3.67		
6.3	1166	222	1.84			130	65	10.78	4.36		
6.8	1077	205	1.99								
				TS 78TR38	4						
				TSF 78TR38	4	46	182	30.33	0.88		
				TSA 78TR38	4	50	167	27.74	0.96		
				TSAF78TR38	4	54	156	25.93	1.03	TS 48	4
6.4	1150	219	1.04			62	135	22.41	1.19	TSF 48	4
				TS 98	8	74	114	19.04	1.40	TSA 48	4
3.0	2136	230.48	1.76	TSF 98	8	82	102	17.00	1.57	TSAF48	4
3.3	1923	207.48	1.96	TSA 98	8	96	87	14.52	1.84		
3.6	1742	187.89	2.16	TSAF98	8	103	82	13.60	1.96		
				TS 98	6	122	69	11.46	2.33		
3.9	1596	230.48	2.36	TSF 98	6						
4.4	1437	207.48	2.62	TSA 98	6						
4.8	1301	187.89	2.89	TSAF98	6						
				TS 88	4						
6.3	999	222.00	2.14	TSF 88	4	<b>1.5kW</b>					
7.1	891	198.00	2.40	TSA 88	4	2.0	4383	714	0.86		
8.4	749	166.43	2.86	TSAF88	4	2.2	4484	626	0.84	TS 98TR58	4
9.2	689	152.95	3.11			2.6	3853	538	0.98	TSF 98TR58	4
10.3	612	135.83	3.50			2.9	3467	484	1.08	TSA 98TR58	4
						3.3	3008	420	1.25	TSAF98TR58	4
						3.7	2693	376	1.40		
						4.3	2342	327	1.61		
5.8	1085	241.09	1.10			2.9	2481	485	0.86		
6.8	928	206.04	1.29			3.2	2225	435	0.96		
7.4	850	188.89	1.40	TS 78	4	3.7	2707	378	0.79	TS 88TR58	4
8.4	746	165.75	1.60	TSF 78	4	4.3	2313	323	0.93	TSF 88TR58	4
8.9	707	157.08	1.69	TSA 78	4	5.0	2013	281	1.06	TSA 88TR58	4
10	619	137.48	1.93	TSAF78	4	5.5	1826	255	1.17	TSAF88TR58	4
11	558	123.86	2.14			6.3	1590	222	1.35		
13	489	108.65	2.44			6.8	1468	205	1.46		
15	432	95.88	2.77								
						3.0	2871	230.48	1.31	TS 98	8
11	585	130.00	0.84			3.3	2584	207.48	1.45	TSF 98	8
12	515	114.38	0.95			3.7	2340	187.89	1.61	TSA 98	8
13	486	108.00	1.01			4.1	2076	166.62	1.81	TSAF98	8
15	414	91.96	1.18								
17	376	83.57	1.30			4.0	2153	230.48	1.75	TS 98	6
19	326	72.39	1.50	TS 68	4	4.4	1938	207.48	1.94	TSF 98	6
22	341	65.00	1.43	TSF 68	4	4.9	1755	187.89	2.14	TSA 98	6
22	284	63.00	1.72	TSA 68	4	5.5	1557	166.62	2.42	TSAF98	6
24	300	57.19	1.63	TSAF68	4						
26	284	54.00	1.72			6.1	1415	230.48	2.66	TS 98	4
30	242	45.98	2.02			6.7	1274	207.48	2.95	TSF 98	4
34	220	41.79	2.23			7.5	1154	187.89	3.26	TSA 98	4
39	190	36.20	2.57								
44	165	31.50	2.96								
53	139	26.40	3.53			4.1	2074	222.00	1.03	TS 88	6
						4.6	1850	198.00	1.16	TSF 88	6
						5.5	1555	166.43	1.38	TSA 88	6
						6.0	1429	152.95	1.50	TSAF88	6

选型参数表  
Selection Table



输出转速 Output speed r/min	输出扭矩 Output torque Nm	传动比 Ratio i	服务系数 Service factor f <sub>s</sub>	机型号 Type Type	极数 Pole p	输出转速 Output speed r/min	输出扭矩 Output torque Nm	传动比 Ratio i	服务系数 Service factor f <sub>s</sub>	机型号 Type Type	极数 Pole p
<b>1.5kW</b>						<b>2.2kW</b>					
6.3	1363	222.00	1.56			3.4	4350	420	0.86		
7.1	1216	198.00	1.76			3.8	3894	376	0.97	TS 98TR58	4
8.4	1022	166.43	2.10	TS 88	4	4.3	3387	327	1.11	TSF 98TR58	4
9.2	939	152.95	2.28	TSF 88	4	4.9	2972	287	1.26	TSA 98TR58	4
10	834	135.83	2.57	TSA 88	4	5.6	2610	252	1.44	TSAF98TR58	4
12	746	121.44	2.87	TSAF88	4						
13	670	109.19	3.20			4.1	3091	230.48	1.22	TS 98	6
15	582	94.77	3.68			4.5	2782	207.48	1.35	TSF 98	6
						5.0	2520	187.89	1.49	TSA 98	6
										TSAF98	6
7.4	1160	188.89	1.03			6.2	2046	230.48	1.84		
8.4	1018	165.75	1.17			6.8	1842	207.48	2.04		
8.9	964	157.08	1.24			7.6	1668	187.89	2.25	TS 98	4
10	844	137.48	1.41			8.5	1479	166.62	2.54	TSF 98	4
11	760	123.86	1.57			9.4	1337	150.64	2.81	TSA 98	4
13	667	108.65	1.79	TS 78	4	11	1133	127.68	3.32	TSAF98	4
15	589	95.88	2.03	TSF 78	4	13	990	111.52	3.80		
16	522	85.00	2.29	TSA 78	4	15	828	93.27	4.54		
18	564	78.78	2.12	TSAF78	4	17	863	83.31	4.36		
19	517	72.22	2.31								
22	454	63.38	2.63			6.4	1971	222.00	1.08		
23	430	60.06	2.78			7.2	1758	198.00	1.22		
27	377	52.57	3.17			8.5	1477	166.43	1.45		
30	339	47.36	3.52			9.3	1358	152.95	1.58		
34	298	41.54	4.01			10	1206	135.83	1.78	TS 88	4
						12	1078	121.44	1.99	TSF 88	4
17	513	83.57	0.95			13	969	109.19	2.21	TSA 88	4
19	444	72.39	1.10			15	841	94.77	2.55	TSAF88	4
22	466	65.00	1.05			17	753	84.86	2.84		
22	387	63.00	1.26			19	783	75.63	2.74		
24	410	57.19	1.19			20	625	70.40	3.43		
26	387	54.00	1.26			21	700	67.62	3.06		
30	329	45.98	1.48	TS 68	4	23	630	60.80	3.40		
34	299	41.79	1.63	TSF 68	4	27	547	52.77	3.92		
39	259	36.20	1.89	TSA 68	4						
44	226	31.50	2.17	TSAF68	4	10	1220	137.48	0.98		
53	216	26.40	2.26			11	1100	123.86	1.09		
59	195	23.83	2.51			13	965	108.65	1.24		
67	171	20.92	2.86			15	851	95.88	1.40		
71	162	19.80	3.02			17	755	85.00	1.58		
83	138	16.86	3.54			18	816	78.78	1.46		
91	125	15.32	3.90			20	748	72.22	1.60		
106	109	13.27	4.50			22	656	63.38	1.82	TS 78	4
121	95	11.55	5.17			24	622	60.06	1.92	TSF 78	4
						27	544	52.57	2.19	TSA 78	4
43	235	32.80	1.20			30	491	47.36	2.43	TSAF78	4
54	214	26.11	1.32			34	430	41.54	2.78		
57	200	24.40	1.41			39	380	36.66	3.14		
66	173	21.09	1.63	TS 58	4	44	337	32.50	3.55		
78	147	17.92	1.92	TSF 58	4	51	287	27.75	4.15		
88	131	16.00	2.15	TSA 58	4	55	307	25.93	3.89		
102	112	13.67	2.52	TSAF58	4	62	269	22.75	4.43		
109	105	12.80	2.69			66	255	21.56	4.68		
130	88	10.78	3.20								
						31	476	45.98	1.03		
96	119	14.52	1.35	TS 48	4	34	433	41.79	1.13		
103	111	13.60	1.44	TSF 48	4	39	375	36.20	1.30		
122	94	11.46	1.71	TSA 48	4	45	326	31.50	1.50		
				TSAF48	4	54	312	26.40	1.56	TS 68	4
						60	282	23.83	1.73	TSF 68	4
						68	248	20.97	1.97	TSA 68	4
						72	234	19.80	2.09	TSAF68	4
						84	200	16.86	2.45		
						93	181	15.32	2.70		
						107	157	13.27	3.11		
						123	137	11.55	3.58		

**选型参数表**  
Selection Table

输出转速 Output speed r/min	输出扭矩 Output torque Nm	传动比 Ratio i	服务系数 Service factor f <sub>s</sub>	机型号 Type Type	极数 Pole p	输出转速 Output speed r/min	输出扭矩 Output torque Nm	传动比 Ratio i	服务系数 Service factor f <sub>s</sub>	机型号 Type Type	极数 Pole p
<b>2.2kW</b>						<b>3kW</b>					
89	189	16.00	1.49	TS 58	4	39	511	36.20	0.96		
104	162	13.67	1.74	TSF 58	4	45	445	31.50	1.10		
111	152	12.80	1.86	TSA 58	4	54	426	26.40	1.15		
132	128	10.78	2.21	TSAF58	4	60	385	23.83	1.27	TS 68	4
<b>3kW</b>						68	338	20.97	1.44	TSF 68	4
4.9	4053	287	0.93	TS 98TR58	4	72	320	19.80	1.53	TSA 68	4
				TSF 98TR58	4	84	272	16.86	1.80	TSAF68	4
				TSA 98TR58	4	93	247	15.32	1.98		
				TSAF98TR58	4	107	214	13.27	2.28		
						123	186	11.55	2.62		
6.2	2790	230.48	1.35			104	221	13.67	1.28	TS 58	4
6.8	2512	207.48	1.50			111	207	12.80	1.36	TSF 58	4
7.6	2275	187.89	1.65			132	174	10.78	1.62	TSA 58	4
8.5	2017	166.62	1.86	TS 98	4					TSAF58	4
9.4	1824	150.64	2.06	TSF 98	4	<b>4kW</b>					
11	1546	127.68	2.43	TSA 98	4	6.2	3668	230.48	1.02		
13	1350	111.52	2.79	TSAF98	4	6.9	3302	207.48	1.14		
15	1129	93.27	3.33			7.7	2991	187.89	1.26		
17	1177	83.31	3.20			8.6	2652	166.62	1.42		
18	978	80.75	3.85			9.6	2398	150.64	1.57	TS 98	4
8.5	2015	166.43	1.06			11	2032	127.68	1.85	TSF 98	4
9.3	1852	152.95	1.16			13	1775	111.52	2.12	TSA 98	4
10	1644	135.83	1.30			15	1485	93.27	2.53	TSAF98	4
12	1470	121.44	1.46			17	1547	83.31	2.43		
13	1322	109.19	1.62			18	1285	80.75	2.93		
15	1147	94.77	1.87			19	1399	75.32	2.69		
17	1027	84.86	2.09	TS 88	4	23	1185	63.84	3.17		
19	1068	75.63	2.01	TSF 88	4	26	1035	55.76	3.63		
20	852	70.40	2.51	TSA 88	4	12	1933	121.44	1.11		
21	955	67.62	2.24	TSAF88	4	13	1738	109.19	1.23		
23	859	60.80	2.50			15	1508	94.77	1.42		
27	745	52.77	2.88			17	1351	84.86	1.59		
30	667	47.25	3.21			19	1404	75.63	1.53		
33	696	42.89	3.08			20	1121	70.40	1.91		
36	554	39.20	3.87			21	1256	67.62	1.71		
37	617	38.25	3.47			24	1129	60.80	1.90	TS 88	4
42	481	34.09	4.45			27	980	52.77	2.19	TSF 88	4
17	1029	85.00	1.16			30	877	47.25	2.44	TSA 88	4
18	1113	78.78	1.07			33	915	42.89	2.34	TSAF88	4
20	1020	72.22	1.17			37	728	39.20	2.94		
22	895	63.38	1.33			38	812	38.25	2.64		
24	848	60.06	1.41			42	633	34.09	3.39		
27	742	52.57	1.61			45	682	32.15	3.14		
30	669	47.36	1.79			49	627	29.55	3.42		
34	587	41.54	2.04	TS 78	4	55	557	26.24	3.85		
39	518	36.66	2.31	TSF 78	4	61	498	23.46	4.30		
44	459	32.50	2.60	TSA 78	4	24	1115	60.06	1.07		
51	392	27.75	3.05	TSAF78	4	27	976	52.57	1.22		
55	419	25.93	2.85			30	879	47.36	1.36		
62	367	22.75	3.25			35	771	41.54	1.55		
66	348	21.56	3.43			39	681	36.66	1.75		
75	305	18.87	3.92			44	604	32.50	1.98		
84	274	17.00	4.35			52	515	27.75	2.32	TS 78	4
95	241	14.91	4.96			56	550	25.93	2.17	TSF 78	4
108	212	13.16	5.62			63	483	22.75	2.47	TSA 78	4
122	188	11.67	6.34			67	458	21.56	2.61	TSAF78	4
143	161	9.96	7.43			76	400	18.87	2.98		
						85	361	17.00	3.31		
						97	316	14.91	3.77		
						109	279	13.16	4.28		
						123	248	11.67	4.82		
						145	211	9.96	5.65		



选型参数表  
Selection Table



输出转速 Output speed r/min	输出扭矩 Output torque Nm	传动比 Ratio i	服务系数 Service factor f <sub>s</sub>	机型号 Type Type	极数 Pole p	输出转速 Output speed r/min	输出扭矩 Output torque Nm	传动比 Ratio i	服务系数 Service factor f <sub>s</sub>	机型号 Type Type	极数 Pole p
<b>4kW</b>						<b>7.5kW</b>					
73	420	19.80	1.16			13	3304	111.52	1.14		
85	358	16.86	1.37	TS 68	4	16	2764	93.27	1.36		
94	325	15.32	1.50	TSF 68	4	18	2880	83.31	1.31		
109	282	13.27	1.74	TSA 68	4	18	2393	80.75	1.57		
125	245	11.55	1.99	TSAF68	4	19	2604	75.32	1.44		
<b>5.5kW</b>						<b>11kW</b>					
8.6	3647	166.62	1.03			26	2808	55.76	1.34		
9.6	3297	150.64	1.14			31	2349	46.64	1.60		
11	2794	127.68	1.35			36	2034	40.38	1.85		
13	2441	111.52	1.54			40	2095	36.39	1.80	TS 98	4
15	2041	93.27	1.84	TS 98	4	45	1886	32.76	1.99	TSF 98	4
17	2127	83.31	1.77	TSF 98	4	49	1708	29.67	2.20	TSA 98	4
18	1767	80.75	2.13	TSA 98	4	55	1514	26.31	2.48	TSAF98	4
19	1923	75.32	1.96	TSAF98	4	61	1369	23.79	2.75		
23	1630	63.84	2.31			72	1160	20.16	3.24		
26	1424	55.76	2.64			83	1014	17.61	3.71		
31	1191	46.64	3.16			99	848	14.73	4.43		
36	1031	40.38	3.65			115	734	12.75	5.12		
17	1857	84.86	1.15			<b>7.5kW</b>					
19	1931	75.63	1.11			31	1633	47.25	1.31		
20	1541	70.40	1.39			34	1704	43.13	1.26		
21	1727	67.62	1.24			37	1355	39.20	1.58		
24	1552	60.80	1.38			38	1511	38.25	1.42		
27	1347	52.77	1.59			43	1178	34.09	1.82		
30	1206	47.25	1.78			45	1270	32.15	1.69	TS 88	4
33	1259	42.89	1.70	TS 88	4	49	1167	29.55	1.84	TSF 88	4
37	1001	39.20	2.14	TSF 88	4	56	1037	26.24	2.07	TSA 88	4
38	1116	38.25	1.92	TSA 88	4	69	833	21.09	2.57	TSAF88	4
42	870	34.09	2.46	TSAF88	4	80	723	18.31	2.96		
45	938	32.15	2.28			89	648	16.39	3.31		
49	862	29.55	2.49			107	537	13.60	3.99		
55	766	26.24	2.80			123	467	11.83	4.59		
61	685	23.46	3.13			<b>5.5kW</b>					
68	615	21.09	3.48			53	959	27.75	1.24		
79	534	18.31	4.01			56	1024	25.93	1.17		
88	478	16.39	4.48			64	899	22.75	1.33	TS 78	4
106	397	13.60	5.40			68	852	21.56	1.40	TSF 78	4
122	345	11.83	6.21			77	746	18.87	1.60	TSA 78	4
<b>4kW</b>						86	672	17.00	1.78	TSAF78	4
94	447	15.32	1.09	TS 68	4	98	589	14.91	2.03		
109	387	13.27	1.26	TSF 68	4	111	520	13.16	2.30		
125	337	11.55	1.45	TSA 68	4	125	461	11.67	2.59		
				TSAF68	4	147	394	9.96	3.03		

**选型参数表**  
Selection Table

输出转速 Output speed r/min	输出扭矩 Output torque Nm	传动比 Ratio i	服务系数 Service factor f <sub>s</sub>	机 型 号 Type Type	极 数 Pole p
<b>15kW</b>					
31	3203	46.64	1.17		
36	2773	40.38	1.36		
40	2856	36.39	1.32		
45	2571	32.76	1.46	TS 98	4
49	2329	29.67	1.61	TSF 98	4
55	2065	26.31	1.82	TSA 98	4
61	1867	23.79	2.01	TSAF98	4
72	1582	20.16	2.38		
83	1382	17.61	2.72		
99	1156	14.73	3.25		
115	1001	12.75	3.76		
89	1287	16.39	1.67	TS 88	4
107	1068	13.60	2.01	TSF 88	4
123	929	11.83	2.31	TSA 88	4
				TSAF88	4
<b>18.5kW</b>					
40	3499	36.39	1.07		
45	3150	32.76	1.19		
50	2853	29.67	1.32	TS 98	4
56	2530	26.31	1.49	TSF 98	4
62	2287	23.79	1.64	TSA 98	4
73	1938	20.16	1.94	TSAF98	4
83	1693	17.61	2.22		
100	1416	14.73	2.65		
115	1226	12.75	3.07		
<b>22kW</b>					
56	3008	26.31	1.25		
62	2720	23.79	1.38	TS 98	4
73	2305	20.16	1.63	TSF 98	4
83	2014	17.61	1.87	TSA 98	4
100	1684	14.73	2.23	TSAF98	4
115	1458	12.75	2.58		

选型参数表  
Selection Table



Mamax Permissible torque Nm	输出转速 Output speed r/min	传动比 Ratio i	机 型 号 Type Type	功率 Power kW/4p	Mamax Permissible torque Nm	输出转速 Output speed r/min	传动比 Ratio i	机 型 号 Type Type	功率 Power kW/4p
90	7.8	179	TS 38TR18 TSF 38TR18 TSA 38TR18 TSAF38TR18	0.18	2280	0.24	5875	TS 88TR58 TSF 88TR58 TSA 88TR58 TSAF88TR58	0.18
	8.8	158				0.27	5187		
	9.7	144				0.30	4606		
	12	118				0.36	3872		
170	13	110	TS 48TR18 TSF 48TR18 TSA 48TR18 TSAF48TR18	0.25		0.40	3475		0.25
	3.6	388				0.48	2905		
	4.1	336				0.54	2586		
	4.7	294				0.60	2335		
	5.4	257				0.68	2054		
	6.1	229				0.76	1824		
	7.0	200			0.85	1631			
	7.4	187			1.0	1332			
8.4	165	1.2	1191						
300	2.4	574	TS 58TR18 TSF 58TR18 TSA 58TR18 TSAF58TR18	0.18	1.3	1032	0.55		
	2.7	506			1.5	930			
	3.2	438			1.7	831			
	3.6	388			1.9	719			
	4.1	336			2.2	624			
	4.7	294			2.5	558			
	5.2	269			2.9	485			
	6.1	229			3.2	435			
	6.8	204			3.7	378			
	7.4	187			4.4	323			
8.4	165	5.1	281						
11	131	0.16	8608	0.18					
520	1.3	1045	0.18		7554				
	1.5	914	0.21		6640				
	1.7	809	0.24		5780				
	2.0	712	0.28		4937				
	2.3	615	0.31		4444				
	2.6	543	0.35		4017				
	3.0	469	0.40		3453				
	3.3	424	0.45		3108				
	3.8	365	0.52		2654				
	4.4	319	0.60	2329					
4.9	281	0.67	2081	0.55					
5.7	246	0.75	1860						
6.3	221	0.88	1574						
7.0	198	1.0	1394						
1270	0.45	3098	TS 78TR38 TSF 78TR38 TSA 78TR38 TSAF78TR38		0.18	1.1	1223	TS 98TR58 TSF 98TR58 TSA 98TR58 TSAF98TR58	0.75
	0.67	2083				1.3	1070		
	0.77	1813				1.5	928		
	0.80	1745				1.7	824		
	0.87	1600				2.0	714		
	1.0	1404				2.2	626		
	1.1	1245		2.6		538			
	1.3	1100		2.9		484			
	1.5	954		3.4		420			
	1.7	837		3.8		376			
1.9	714	4.3	327	3					
2.2	637	4.9	287						
2.4	574	5.7	252						
2.8	499	6.6	219						
3.2	438	0.75	0.75						
3.6	389	1.1	1.1						
4.3	327	1.5	1.5						
4.8	289	2.2	2.2						
5.6	250	3	3						
6.4	219	4	4						

表上所配功率均有超载,按实际条件确定的转矩不得大于减速机额定转矩。 The power are all overload in the table. The decided torque according to operating condition should not more than gear units' nominal torque.



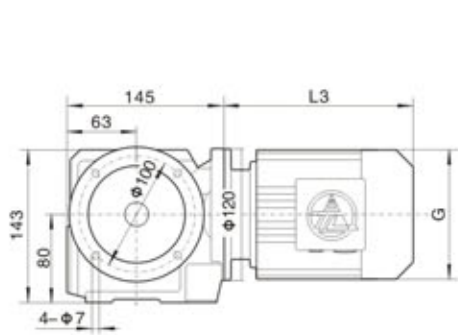

**TSF38/φ120**

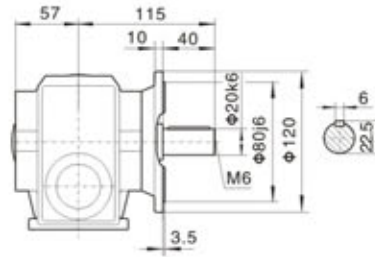

**TSAF38/φ120**

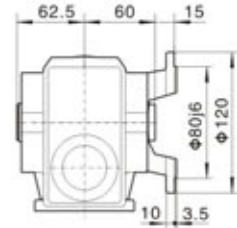

**TSF38/φ160**

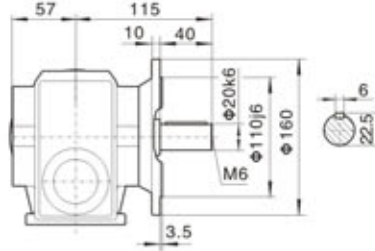

**TSAF38/φ160**

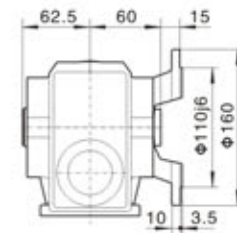

**TSA38**

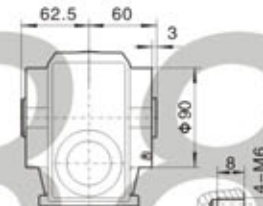
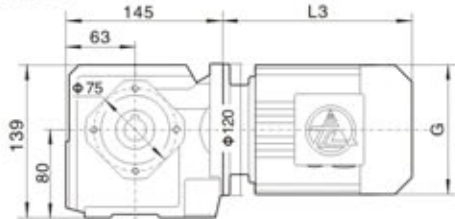

**TSAF38/TSA38**

空心轴/Hollow shaft



**TS38**

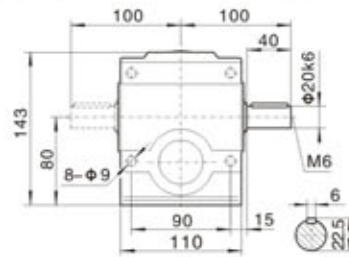
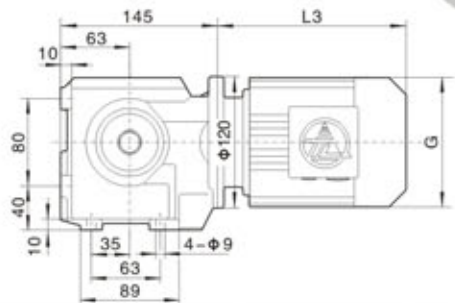

**TS..38TR18**

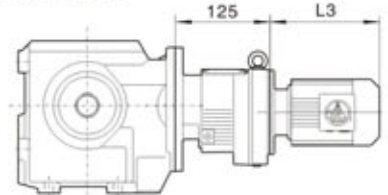

**TS..S38**

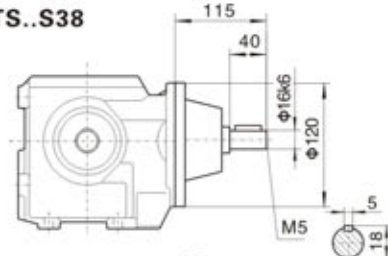

**TSAT38**

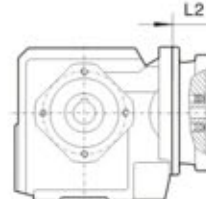
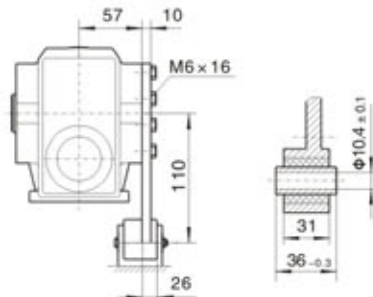
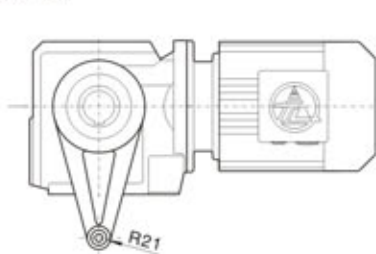

电机需方配或配特殊电机时需加联接法兰  
When equipping the user's motor or the special one, the flange is required to connected.

注: 其余尺寸见相对应结构形式  
Note: For other values please refer to the opposed structure.

Y2电机座号 Motor size	63	71	80		
功率/4P Power/(kW)	0.18	0.25 0.37	0.55 0.75		
L3	235	250	293		
G	130	145	175		
L2	56	56	56		

注:1.TSA、TSF、TSAF、TSAZ壳体为通用件,安装尺寸均可相互参照。2.\*TS..\*表示TS、TSA、TSF、TSAF、TSAZ 3.带锁紧盘式,详见179页

Note:1.The housings of TSA、TSF、TSAF、TSAZ are common parts.The mounting dimensions may consult each other. 2.\*TS..\*mean TS、TSA、TSF、TSAF、TSAZ 3.Hollow shaft output with shrink disk, see P179 for detail.

# 外形安装尺寸 Mounting Dimension Sheets-overview

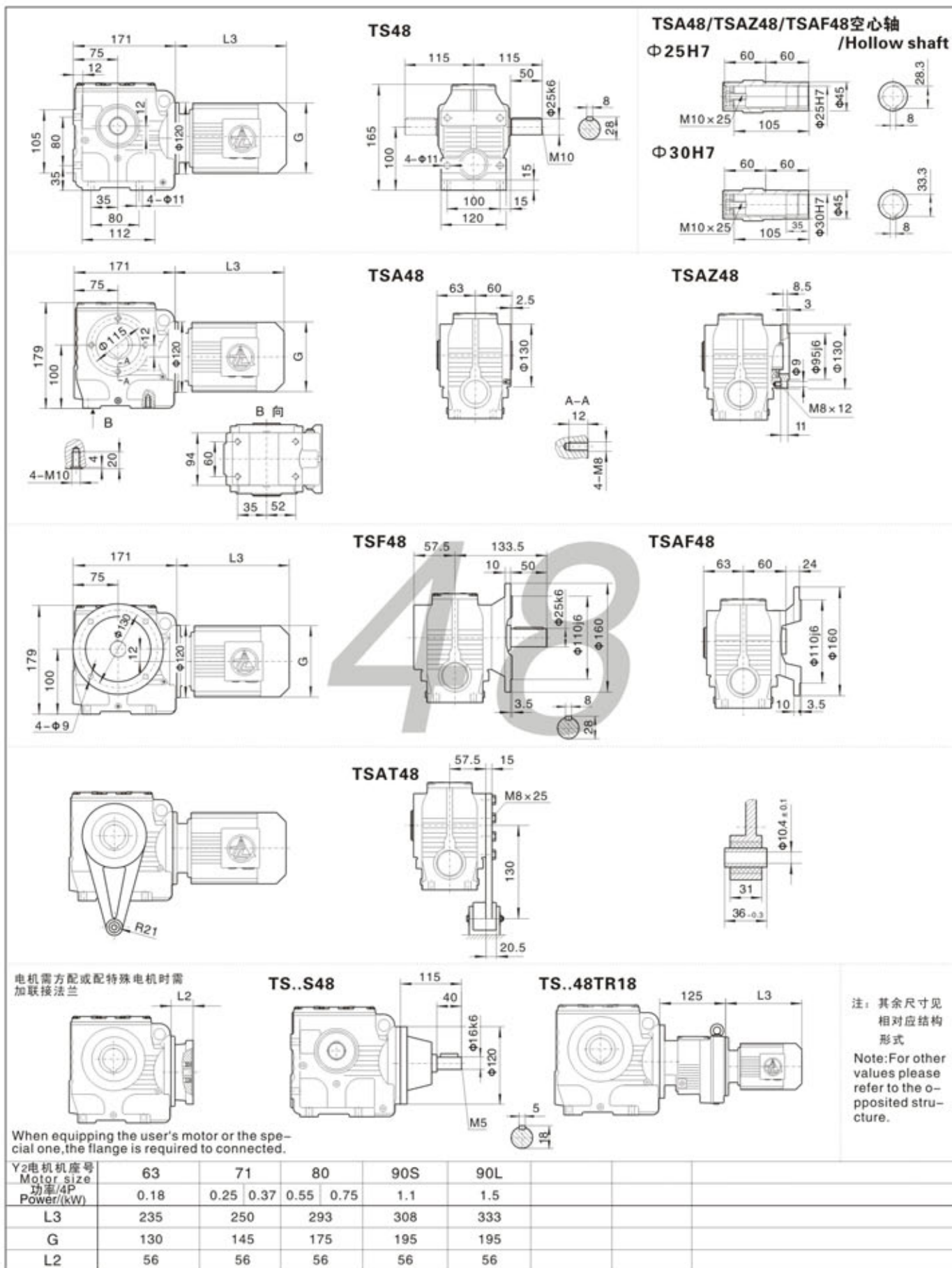

注：其余尺寸见相对应结构形式  
Note: For other values please refer to the o-pposited structure.

注:1.TSA、TSF、TSAF、TSAZ壳体为通用件,安装尺寸均可相互参照。 2.\*TS..\*表示TS、TSA、TSF、TSAF、TSAZ 3.带锁紧盘式,详见179页  
Note:1.The housings of TSA、TSF、TSAF、TSAZ are common parts.The mounting dimensions may consult each other. 2.\*TS..\*mean TS、TSA、TSF、TSAF、TSAZ 3.Hollow shaft output with shrink disk, see P 179 for detail.

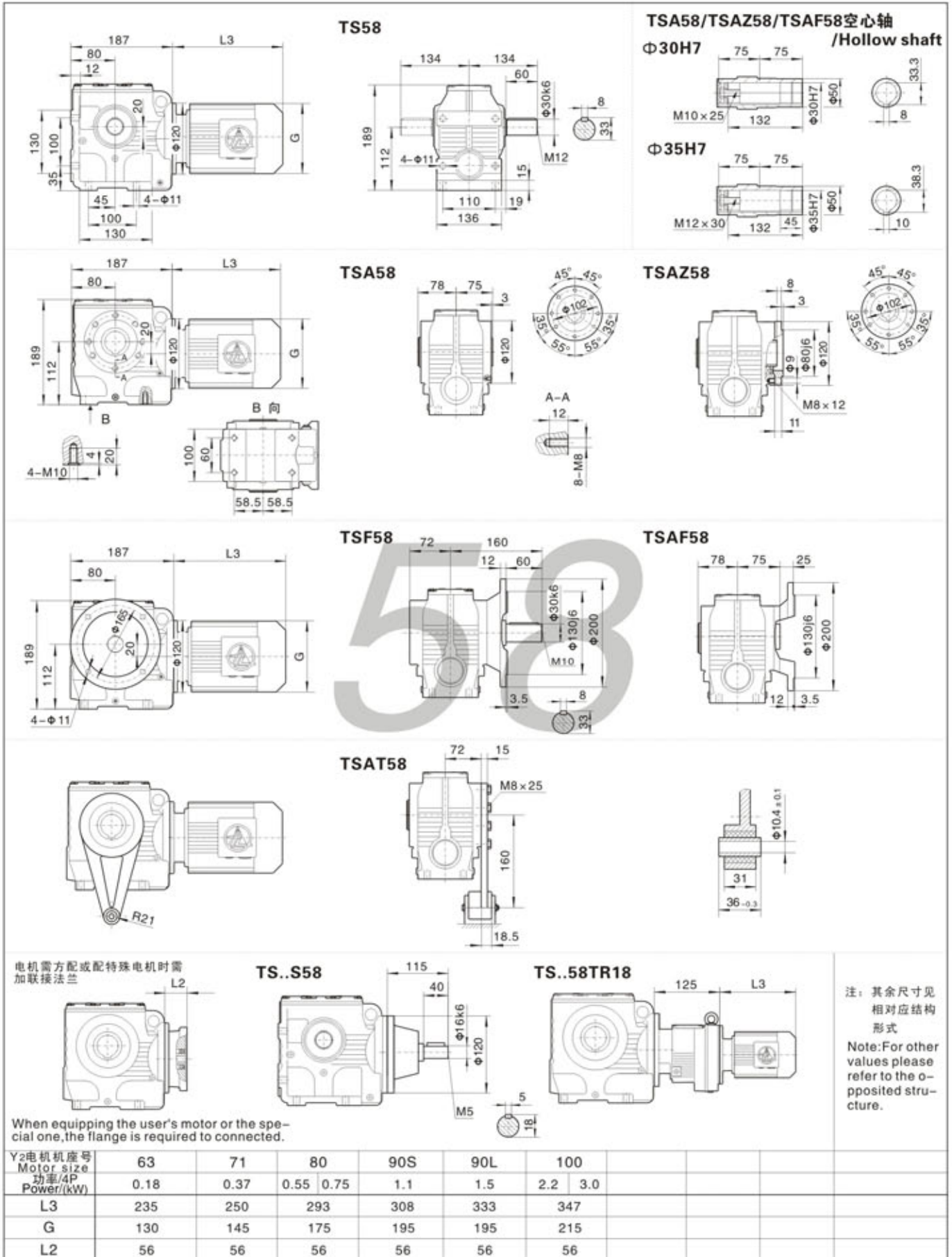

注：其余尺寸见  
相对应结构  
形式  
Note: For other  
values please  
refer to the  
opposite stru-  
cture.

注:1.TSA、TSF、TSAF、TSAZ壳体为通用件,安装尺寸均可相互参照。 2.\*TS..\*表示TS、TSA、TSF、TSAF、TSAZ 3.带锁紧盘式,详见179页  
Note:1.The housings of TSA、TSF、TSAF、TSAZ are common parts.The mounting dimensions may consult each other. 2.\*TS..\*mean TS、TSA、TSF、TSAF、TSAZ  
3.Hollow shaft output with shrink disk, see P 179 for detail.



# 外形安装尺寸 Mounting Dimension Sheets-overview



### TS68

### TSA68/TSAZ68/TSAF68空心轴 /Hollow shaft

#### Φ40H7

#### Φ45H7

### TSA68

### TSAZ68

### TSF68

### TSAF68

### TSAT68

### TS..S68

### TS..68TR38

电机需方配或配特殊电机时需加联接法兰  
When equipping the user's motor or the special one, the flange is required to be connected.

Y2电机座号 Motor size	71	80	90S	90L	100	112M	132S
功率/4P Power/(kW)	0.25 0.37	0.55 0.75	1.1	1.5	2.2 3.0	4.0	5.5
L3	244	293	304	329	357	383	428
G	145	175	195	195	215	240	275
L2	75	75	75	75	68	68	72

注: 其余尺寸见相对应结构形式  
Note: For other values please refer to the o-pposited structure.

注:1.TSA、TSF、TSAF、TSAZ壳体为通用件,安装尺寸均可相互参照。 2.\*TS..\*表示TS、TSA、TSF、TSAF、TSAZ 3.带锁紧盘式,详见179页  
Note:1.The housings of TSA、TSF、TSAF、TSAZ are common parts.The mounting dimensions may consult each other. 2.\*TS..\*mean TS、TSA、TSF、TSAF、TSAZ 3.Hollow shaft output with shrink disk, see P179 for detail.

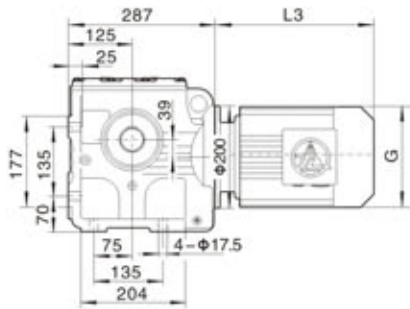

TS78

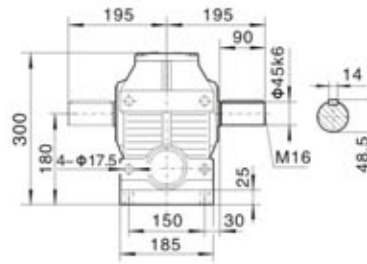

TSA78/TSAZ78/TSAF78空心轴 /Hollow shaft

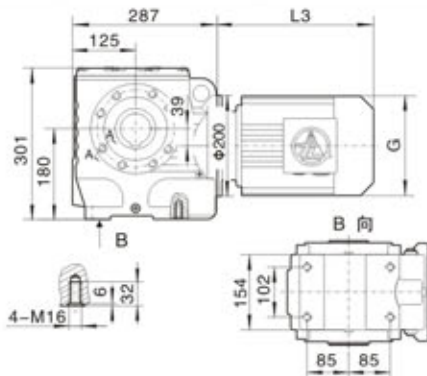
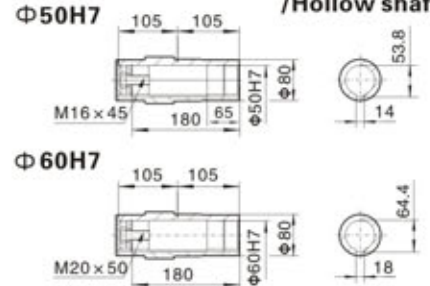

TSA78

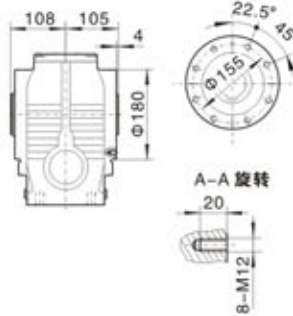

TSAZ78

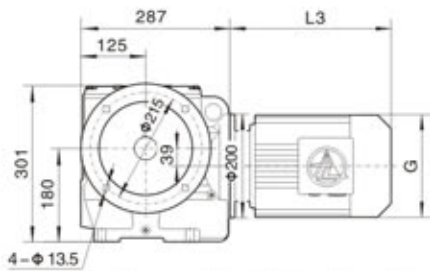
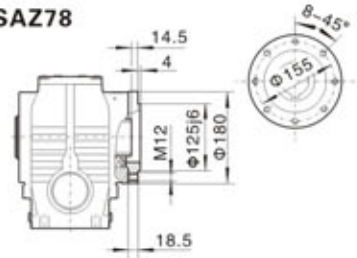

TSF78

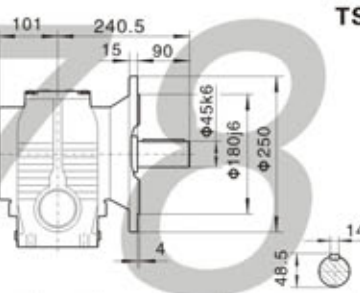

TSAF78

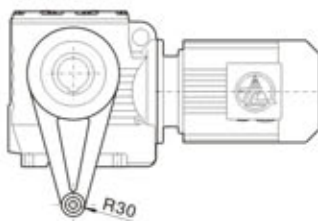
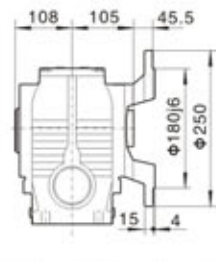

TSAT78

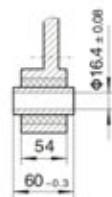
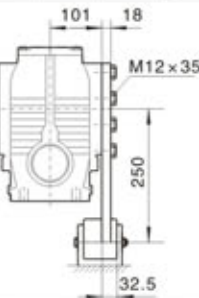

电机需方配或配特殊电机时需加联接法兰

TS..S78

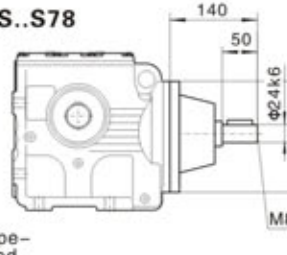
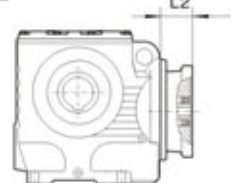

TS..78TR38

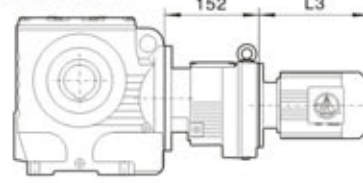

注: 其余尺寸见相对应结构形式  
Note: For other values please refer to the o-pposited structure.

When equipping the user's motor or the special one, the flange is required to be connected.

Y2电机机座号 Motor size	80	90S	90L	100	112M	132S	132M
功率/4P Power/(kW)	0.55 0.75	1.1	1.5	2.2 3.0	4.0	5.5	7.5
L3	292	297	322	354	391	430	463
G	175	195	195	215	240	275	275
L2	64	63.5	63.5	65	65	68	68

注:1.TSA、TSF、TSAF、TSAZ壳体为通用件,安装尺寸均可相互参照。 2.\*TS..\*表示TS、TSA、TSF、TSAF、TSAZ 3.带锁紧盘式,详见179页

Note:1.The housings of TSA、TSF、TSAF、TSAZ are common parts.The mounting dimensions may consult each other. 2.\*TS..\*mean TS、TSA、TSF、TSAF、TSAZ 3.Hollow shaft output with shrink disk, see P 179 for detail.

# 外形安装尺寸 Mounting Dimension Sheets-overview



### TS88

### TSA88/TSAZ88/TSAF88空心轴 /Hollow shaft

**Φ60H7**

**Φ70H7**

### TSA88

### TSAZ88

### TSF88

### TSAF88

### TSAT88

### 电机需方配或配特殊电机时需加联接法兰

### TS..S88

### TS..88TR58

注: 其余尺寸见相对应结构形式  
Note: For other values please refer to the o-posed structure.

Y2电机座号 Motor size	80	90S	90L	100	112M	132S	132M	160M	160L
功率/4P Power/(kW)	0.75	1.1	1.5	2.2 3.0	4.0	5.5	7.5	11	15
L3	261	284	309	351	371	417	450	538	583
G	175	195	195	215	240	275	275	330	330
L2	71	71	71	72	72	83	83	95	95

注:1.TSA、TSF、TSAF、TSAZ壳体为通用件,安装尺寸均可相互参照。 2.\*TS..\*表示TS、TSA、TSF、TSAF、TSAZ 3.带锁紧盘式,详见179页  
Note:1.The housings of TSA、TSF、TSAF、TSAZ are common parts.The mounting dimensions may consult each other. 2.\*TS..\*mean TS、TSA、TSF、TSAF、TSAZ  
3.Hollow shaft output with shrink disk, see P179 for detail.



